



Pot Magnet Catalog

Pot Magnets for mechanical fastening are specifically designed to achieve maximum clamping force on metallic surfaces. The magnet is encased within a **Steel Shell** (cup) that concentrates the entire magnetic flux toward a single direction - the active magnetic face. By directing the magnetic field solely toward the open side of the magnet, this design provides a significantly stronger holding force compared to a standard magnet of the same size without a metal casing. These magnets are designed for **direct contact applications** and are not effective for use across an air gap.

Why Choose Pot Magnets?

- **Concentrated Force:** The specialized structure allows for a clamping force significantly stronger than a standard magnet of equivalent size.
- **Mechanical Durability:** The steel body protects the internal magnet from shattering, cracking, and general wear and tear during repeated attachment and detachment.
- **Easy Installation:** A ready-to-use solution featuring integrated threading or mounting holes for quick and easy assembly.
- **Enhanced Protection:** The robust metal housing ensures the magnet remains intact even when snapped onto heavy metal surfaces.

Our Series Includes:

Series A: Countersunk Hole

Designed for mounting with a countersunk (conical) screw, allowing for a **flush surface** once installed.

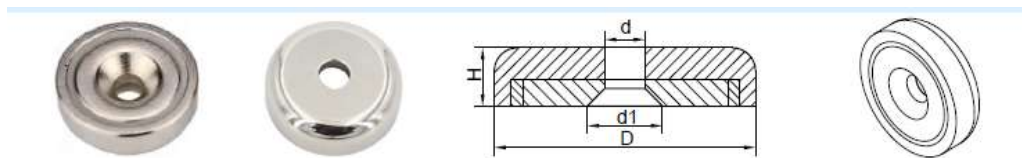

Catalog Number	D (mm)	d (mm)	d1 (mm)	H (mm)	Weight (g)	Pull-off Force (kg)
PMA010005A	10		4.5	5	3	1.5
PMA012005A	12	3.5	4.5	5	4	2.5
PMA016005A	16	3.5	6.5	5	7	6
PMA020007A	20	4.5	8.6	7	11	10
PMA025008A	25	5.5	8.6	8	25	20
PMA032008A	32	5.5	10.6	8	42	33
PMA036008A	36	6.5	10.6	8	53	40



PMA042008A	42	6.5	11.3	8.6	78	65
PMA048011A	48	8.5	14.5	11	135	100
PMA055012A	55	8.5	14.5	12	180	125
PMA060015A	60	8	14.5	15	315	160
PMA075018A	75	10.5	16.5	18	560	250
PMA080018A	80	10.5	16.5	18	668	280
PMA090018A	90	10.5	16.5	18	850	380
PMA120018A	120	12.5	22.5	18	1520	480

Series B: Straight Hole (Through-Hole)

Designed for fastening using a screw or pin that passes directly through the magnet

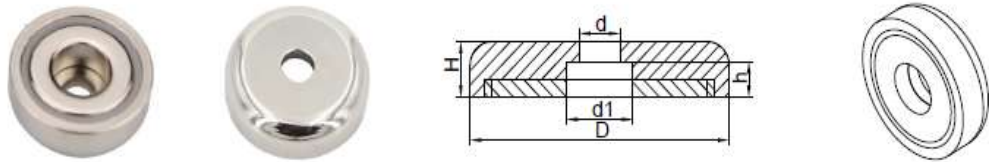

Catalog Number	D (mm)	d (mm)	d1 (mm)	H (mm)	Weight (g)	Pull-off Force (kg)
PMB012005A	12	3.5	6.5	5	4	2
PMB016005A	16	3.5	6.5	5	7	5
PMB020007A	20	4.5	8	7	13	10
PMB025008A	25	5.5	9	8	19	18
PMB032008A	32	5.5	9	8	38	30
PMB036008A	36	6.5	11	8	48	40
PMB042008A	42	6.5	11	8.6	70	60
PMB048011A	48	8.5	15	11	115	70
PMB060015A	60	8.5	15	15	240	150
PMB075018A	75	10.5	18	18	515	220



Series C: External Thread

Includes a protruding threaded stud for direct attachment to nuts or pre-threaded holes.

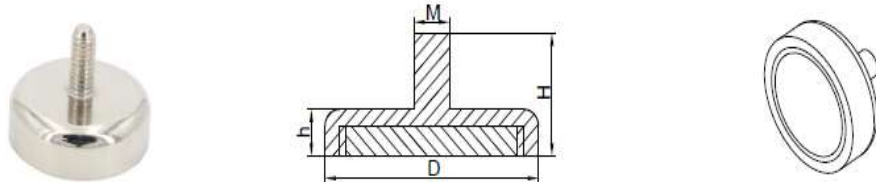

Catalog Number	D (mm)	H (mm)	h (mm) ²	M	Weight (g)	Pull-off Force (kg)
PMC010005A	10	14	5	M3	4	2
PMC012005A	12	14	5	M3	5	4
PMC016005A	16	13.2	5	M4	9	8
PMC020007A	20	16	7	M4	17	12
PMC025008A	25	17	8	M5	31	23
PMC032008A	32	18.5	8	M6	50	34
PMC036008A	36	18	8	M6	62	50
PMC042008A	42	18	8.6	M6	90	70
PMC048011A	48	24	11	M8	160	81
PMC060015A	60	28	15	M8	340	160
PMC075018A	75	35	18	M10	635	250

series D: Internal Thread

Includes a threaded hole that allows for screws, bolts, or threaded rods to be fastened directly into the magnet body.

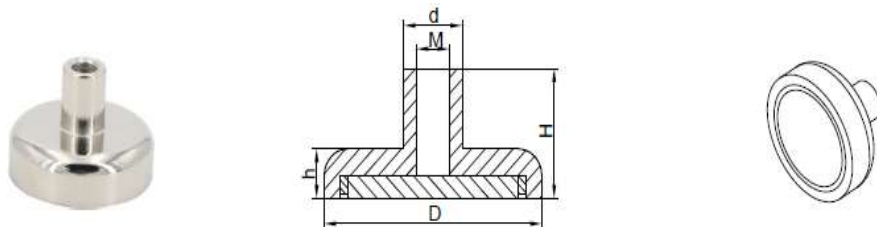

Catalog Number	D (mm)	d (mm) ²	H (mm)	h (mm) ³	M	Weight (g)	Pull-off Force (kg)
PMD010005A	10	6	12.5	5	M3	4	2
PMD012005A	12	6	12.5	5	M3	5	4



PMD016005A	16	6.5	12.6	5	M4	9	8
PMD020007A	20	6.5	14	7	M4	17	12
PMD025008A	25	7.5	17	8	M5	31	23
PMD032008A	32	10	18	8	M6	50	34
PMD036008A	36	10	18	8	M6	62	50
PMD042008A	42	10	18	8.6	M6	90	70
PMD048011A	48	12	24	11	M8	160	81
PMD060015A	60	12	28	15	M8	340	160
PMD075018A	75	17	35	18	M10	635	250

Series E: Hook (Pot Magnet with Hook)

The ideal solution for hanging signage, tools, or equipment securely and quickly.

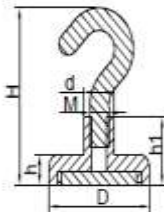

Catalog Number	D (mm)	d (mm) ²	H (mm)	h (mm) ³	M	Weight (g)	Pull-off Force (kg)
PME010005A	10	6	12.5	5	M3	6	2
PME012005A	12	6	12.5	5	M3	7	4
PME016005A	16	6.5	12.6	5	M4	12	8
PME020007A	20	6.5	14	7	M4	21	12
PME025008A	25	7.5	18	8	M5	37	23
PME032008A	32	10	18	8	M6	48	34
PME036008A	36	10	18	8	M6	69	50
PME042008A	42	10	18	8.6	M6	101	72
PME048011A	48	12	24	11	M8	182	81
PME060015A	60	12	28	15	M8	362	160
PME075018A	75	17	35	18	M10	681	270

Important Usage Guidelines

- **Direct Contact:** These magnets are designed for **direct contact (Zero Gap)** applications only. Their holding force decreases significantly as the distance (air gap) from the metallic surface increases.



- **Shear Force Resistance:** The force required to slide the magnet sideways (**Shear Force**) is always substantially lower than the vertical pull-off force.
- **Surface Compatibility:** These are best suited for use on steel and other ferromagnetic materials.

For Consultation & Orders:

- **Phone:** +972-72-2150592
- **Email:** sales3@magmamagnets.com